



GarageDoorMinder®

Pairing and Use Instructions



GarageDoorMinder®

Changing Receiver Functions



FOLLOW THESE 3 EASY STEPS FOR SUCCESSFUL INSTALLATION & USE



Transmitter



Receiver

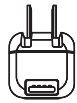

Wall Plug Adapter

1. Remove both plastic battery tabs from Transmitter(s)*. Place Transmitter(s) on a flat surface with front of Transmitter(s) facing down (Fig. 1). This position places the Transmitter(s) into transmit mode. The battery door of the Transmitter(s) will be facing up as shown.

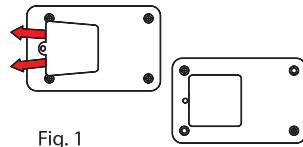

Fig. 1

2. Plug Receiver(s)* into wall plug adapter and plug adapter into power outlet (Fig. 2). The Receiver(s) will beep and blink twice to indicate that they are in pairing mode. When Receiver(s) flash continuously (after about 30 seconds) the pairing of the Transmitter(s) and Receiver(s) is complete.

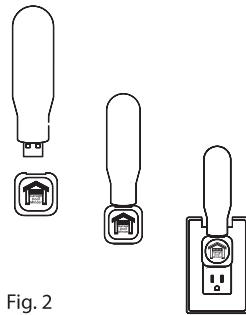

Fig. 2

If pairing fails, unplug the Receiver(s) from the power outlet and plug back in. The Receiver(s) will beep and blink twice to indicate that they are in pairing mode. Transmitter(s) and Receiver(s) must be within 5 feet of each other during the pairing process. Pairing is memorized and will be saved even if Receiver(s) are unplugged from the power outlet.

3. Choose a clean smooth surface at the top of the garage door. With the wet cleaning cloth provided clean a 2x2-inch area thoroughly. Let dry for 30 seconds. Slide Transmitter into mounting clip. Peel backing film from tape on the clip and firmly stick Transmitter and mounting clip to the cleaned area on door as shown (Fig. 3).

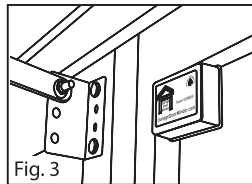

Fig. 3

***Multiple Transmitters and Receivers can be paired to operate together. Simply place all Transmitters in transmit mode and plug in all Receivers at the same time.**

For step-by-step video instructions visit our website at: GarageDoorMinder.com or call Customer Service at (916) 640-3960.

Functions:

- Beeper OFF.
- Beeper 50% Volume.
- Beeper Delay for 45 Seconds.
- Reset Receiver



1. Beeper OFF:

Press and hold button until 1 light lights up then release. Beeper is now off.



2. Beeper ON:

Press and hold button until 2 lights light up then release. Beeper is now on 100% volume.



3. Beeper 50% Volume:

Press and hold button until 3 lights light up then release. Beeper is now set at 50% volume. To return to 100% volume follow step 2.



4. Beeper Delay for 45 Seconds:

Press hold button until you see 2 center lights light up then release. Beeper is now delayed for 45 seconds.



5. Reset Receiver:

Press and hold button until the top and bottom lights light up then release. Receiver is now reset and in pairing mode for 30 seconds. If the 30 second pairing sequence elapses, unplug the Receiver from the power outlet then plug back in. Receiver will beep and blink twice and is now in pairing mode again for 30 seconds. Follow instructions on opposite side of this sheet (#2) to pair Transmitter(s) and Receiver(s).

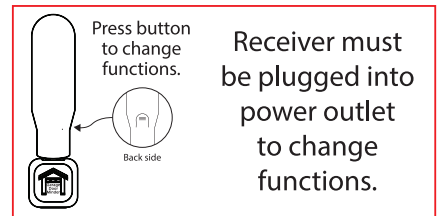

Use Two-Commas Genuine Long-Life ER14250 replacement batteries for best performance.



Scan QR Code to Buy: 

Buy on Amazon: <https://a.co/d/01sGRg0m>

Add an extra Receiver Lightstick to get notifications anywhere in your home.



Scan QR Code to Buy: 

Buy on Amazon: <https://a.co/d/0940aCFL>

Two Commas LLC
West Sacramento, CA (916) 640-3960
info@GarageDoorMinder.com
GarageDoorMinder.com

FCC IC Two-Commas Model M820
FCC ID: 2A7ZY-M820-TXR IC: 28839-M820TXR
Two-Commas Model M811
FCC ID: 2A7ZY-M811-TX IC: 28839-M811TX

©2018-2024 Two Commas LLC

GDM_Manual_Rev12_062024



GarageDoorMinder®

Pairing and Use Instructions



GarageDoorMinder®

Changing Receiver Functions



FOLLOW THESE 3 EASY STEPS FOR SUCCESSFUL INSTALLATION & USE



Transmitter

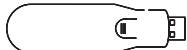

Receiver



Wall Plug Adapter

1. Remove both plastic battery tabs from Transmitter(s)*. Place Transmitter(s) on a flat surface with front of Transmitter(s) facing down (Fig. 1). This position places the Transmitter(s) into transmit mode. The battery door of the Transmitter(s) will be facing up as shown.

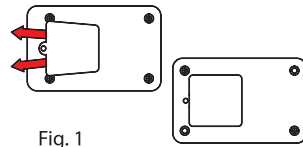

Fig. 1

2. Plug Receiver(s)* into wall plug adapter and plug adapter into power outlet (Fig. 2). The Receiver(s) will beep and blink twice to indicate that they are in pairing mode. When Receiver(s) flash continuously (after about 30 seconds) the pairing of the Transmitter(s) and Receiver(s) is complete.

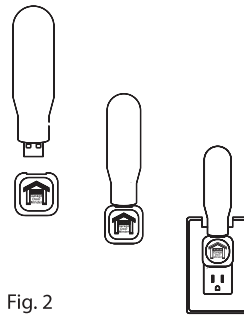

Fig. 2

If pairing fails, unplug the Receiver(s) from the power outlet and plug back in. The Receiver(s) will beep and blink twice to indicate that they are in pairing mode. Transmitter(s) and Receiver(s) must be within 5 feet of each other during the pairing process. Pairing is memorized and will be saved even if Receiver(s) are unplugged from the power outlet.

3. Choose a clean smooth surface at the top of the garage door. With the wet cleaning cloth provided clean a 2x2-inch area thoroughly. Let dry for 30 seconds. Slide Transmitter into mounting clip. Peel backing film from tape on the clip and firmly stick Transmitter and mounting clip to the cleaned area on door as shown (Fig. 3).

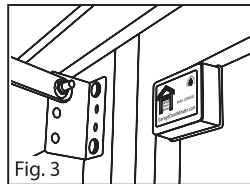

Fig. 3

***Multiple Transmitters and Receivers can be paired to operate together. Simply place all Transmitters in transmit mode and plug in all Receivers at the same time.**

For step-by-step video instructions visit our website at: GarageDoorMinder.com or call Customer Service at (916) 640-3960.

Functions:

- Beeper OFF.
- Beeper 50% Volume.
- Beeper Delay for 45 Seconds.
- Reset Receiver



1. Beeper OFF:

Press and hold button until 1 light lights up then release. Beeper is now off.



2. Beeper ON:

Press and hold button until 2 lights light up then release. Beeper is now on 100% volume.



3. Beeper 50% Volume:

Press and hold button until 3 lights light up then release. Beeper is now set at 50% volume. To return to 100% volume follow step 2.



4. Beeper Delay for 45 Seconds:

Press hold button until you see 2 center lights light up then release. Beeper is now delayed for 45 seconds.



5. Reset Receiver:

Press and hold button until the top and bottom lights light up then release. Receiver is now reset and in pairing mode for 30 seconds. If the 30 second pairing sequence elapses, unplug the Receiver from the power outlet then plug back in. Receiver will beep and blink twice and is now in pairing mode again for 30 seconds. Follow instructions on opposite side of this sheet (#2) to pair Transmitter(s) and Receiver(s).

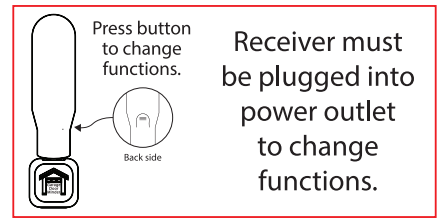

Use Two-Commas Genuine Long-Life ER14250 replacement batteries for best performance.



Scan QR Code to Buy: 

Buy on Amazon: <https://a.co/d/01sGRg0m>

Add an extra Receiver Lightstick to get notifications anywhere in your home.



Scan QR Code to Buy: 

Buy on Amazon: <https://a.co/d/0940aCFL>

Two Commas LLC
West Sacramento, CA (916) 640-3960
info@GarageDoorMinder.com
GarageDoorMinder.com

FCC IC Two-Commas Model M820
FCC ID: 2A7ZY-M820-TXR IC: 28839-M820TXR
Two-Commas Model M811
FCC ID: 2A7ZY-M811-TX IC: 28839-M811TX

©2018-2024 Two Commas LLC

GDM_Manual_Rev12_062024